



Berger Realty, Inc.  
3160 Asbury Avenue  
Ocean City, NJ 08226  
1-877-237-4371 / 609-399-0076  
info@bergerrealty.com



206 Carver Ave, Egg Harbor Township, NJ, 08234

Price \$85,000.00

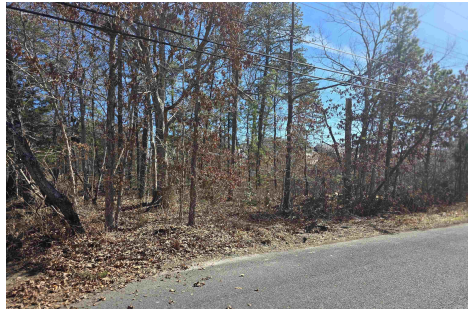

#### PROPERTY DETAILS

|              |         |
|--------------|---------|
| Total Rooms  |         |
| Bedrooms     | 0       |
| Baths Full   | 0       |
| Baths Half   | 0       |
| Year Built   |         |
| Type         |         |
| Block Number | 2715    |
| Listing #    | 594041  |
| Taxes        | 1456.00 |

#### COMMENTS

*This is great location to build a house with lot 100 x 100. This property is close to schools, shopping centers, dining area, Hospital, Supermarket and EHT recreational facilities. This property location offers easy access to major highways and nearby cities. The Buyer has to perform all due diligence....*

#### PROPERTY FEATURES

#### CONTACT



Ask for Michael Devlin  
Berger Realty Inc  
3160 Asbury Avenue, Ocean City  
Call: 609-306-3730  
Email to: msd@bergerrealty.com

Scan to see Property page.



Berger Realty, Inc.  
3160 Asbury Avenue  
Ocean City, NJ 08226  
1-877-237-4371 / 609-399-0076  
info@bergerrealty.com



206 Carver Ave, Egg Harbor Township, NJ, 08234

Price \$85,000.00



#### PROPERTY DETAILS

|              |         |
|--------------|---------|
| Total Rooms  |         |
| Bedrooms     | 0       |
| Baths Full   | 0       |
| Baths Half   | 0       |
| Year Built   |         |
| Type         |         |
| Block Number | 2715    |
| Listing #    | 594041  |
| Taxes        | 1456.00 |

#### COMMENTS

*This is great location to build a house with lot 100 x 100. This property is close to schools, shopping centers, dining area, Hospital, Supermarket and EHT recreational facilities. This property location offers easy access to major highways and nearby cities. The Buyer has to perform all due diligence....*

#### PROPERTY FEATURES

#### CONTACT



Ask for Michael Devlin  
Berger Realty Inc  
3160 Asbury Avenue, Ocean City  
Call: 609-306-3730  
Email to: msd@bergerrealty.com

Scan to see Property page.

