

Berger Realty

Since 1928



Berger Realty, Inc.
3160 Asbury Avenue
Ocean City, NJ 08226
1-877-237-4371 / 609-399-0076
info@bergerrealty.com



662 Dogwood Ave, Egg Harbor Township, NJ, 08234

Price \$15,000.00

PROPERTY DETAILS

Total Rooms	
Bedrooms	0
Baths Full	0
Baths Half	0
Year Built	
Type	
Block Number	3419
Listing #	592378
Taxes	201.00

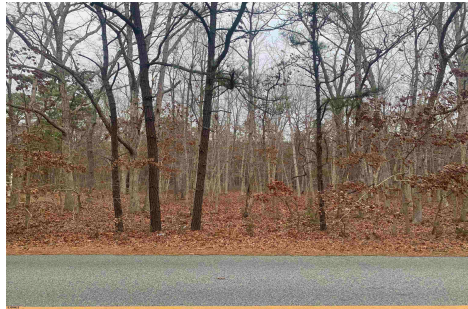

COMMENTS

100 X 100 Foot Lot 10,000 Square Foot Lot Per Egg Harbor Township zoning, you may not build on the site. Property may be purchased for any other approved use appropriate for Egg Harbor Township Most suitable for neighboring properties to add square footage to their adjoining property Quiet residential Street. Seller has no info, Property was purchased at tax sale. Buye...

PROPERTY FEATURES

CONTACT



Ask for Dawn Warren
Berger Realty Inc
3160 Asbury Avenue, Ocean City
Call: 609-432-4966
Email to: dew@bergerrealty.com

Scan to see Property page.



Berger Realty

Since 1928



Berger Realty, Inc.
3160 Asbury Avenue
Ocean City, NJ 08226
1-877-237-4371 / 609-399-0076
info@bergerrealty.com



662 Dogwood Ave, Egg Harbor Township, NJ, 08234

Price \$15,000.00

PROPERTY DETAILS

Total Rooms	
Bedrooms	0
Baths Full	0
Baths Half	0
Year Built	
Type	
Block Number	3419
Listing #	592378
Taxes	201.00

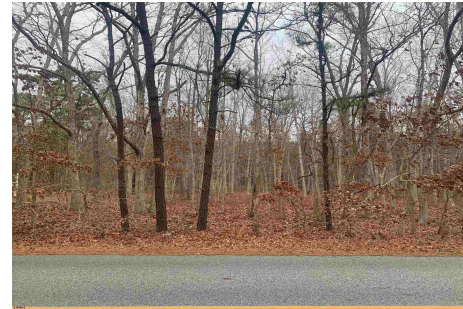

COMMENTS

100 X 100 Foot Lot 10,000 Square Foot Lot Per Egg Harbor Township zoning, you may not build on the site. Property may be purchased for any other approved use appropriate for Egg Harbor Township Most suitable for neighboring properties to add square footage to their adjoining property Quiet residential Street. Seller has no info, Property was purchased at tax sale. Buye...

PROPERTY FEATURES

CONTACT



Ask for Dawn Warren
Berger Realty Inc
3160 Asbury Avenue, Ocean City
Call: 609-432-4966
Email to: dew@bergerrealty.com

Scan to see Property page.

