

# Berger Realty

Since 1926



Berger Realty, Inc.  
3160 Asbury Avenue  
Ocean City, NJ 08226  
1-877-237-4371 / 609-399-0076  
info@bergerrealty.com



6634 Black Horse Pike, Egg Harbor Township, NJ, 08234

Price \$130,000.00

### PROPERTY DETAILS

|              |         |
|--------------|---------|
| Total Rooms  |         |
| Bedrooms     | 0       |
| Baths Full   | 0       |
| Baths Half   | 0       |
| Year Built   |         |
| Type         |         |
| Block Number | 1220    |
| Listing #    | 586993  |
| Taxes        | 2260.00 |



### COMMENTS

*Two irregular, buildable lot for the price of one. Buyer and buyer's agent to do their Due Diligence. Buyer responsible for any approvals, permits, license, certifications and all requirements by the township and coding department. Contact the township for any variances zoning information. Can be purchase as bundle with the adjunction commercial building MLS #586989 or ML...*

### PROPERTY FEATURES

### CONTACT



Ask for Mary Kuchka  
Berger Realty Inc  
3160 Asbury Avenue, Ocean City  
Call: 609-576-2790  
Email to: mk@bergerrealty.com

Scan to see Property page.



# Berger Realty

Since 1926



Berger Realty, Inc.  
3160 Asbury Avenue  
Ocean City, NJ 08226  
1-877-237-4371 / 609-399-0076  
info@bergerrealty.com



6634 Black Horse Pike, Egg Harbor Township, NJ, 08234

Price \$130,000.00

### PROPERTY DETAILS

|              |         |
|--------------|---------|
| Total Rooms  |         |
| Bedrooms     | 0       |
| Baths Full   | 0       |
| Baths Half   | 0       |
| Year Built   |         |
| Type         |         |
| Block Number | 1220    |
| Listing #    | 586993  |
| Taxes        | 2260.00 |

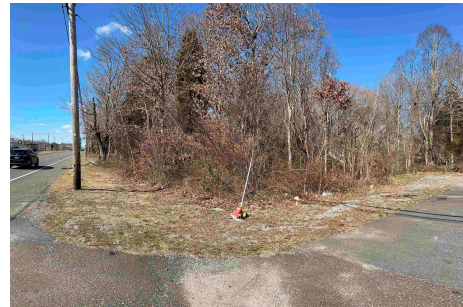

### COMMENTS

*Two irregular, buildable lot for the price of one. Buyer and buyer's agent to do their Due Diligence. Buyer responsible for any approvals, permits, license, certifications and all requirements by the township and coding department. Contact the township for any variances zoning information. Can be purchase as bundle with the adjunction commercial building MLS #586989 or ML...*

### PROPERTY FEATURES

### CONTACT



Ask for Mary Kuchka  
Berger Realty Inc  
3160 Asbury Avenue, Ocean City  
Call: 609-576-2790  
Email to: mk@bergerrealty.com

Scan to see Property page.

