

Berger Realty

Since 1926



Berger Realty, Inc.
3160 Asbury Avenue
Ocean City, NJ 08226
1-877-237-4371 / 609-399-0076
info@bergerrealty.com



851 Moss Mill Road, Galloway Township, NJ, 08205

Price \$135,000.00

PROPERTY DETAILS

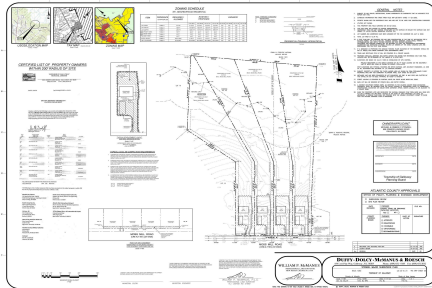

Total Rooms	
Bedrooms	0
Baths Full	0
Baths Half	0
Year Built	
Type	
Block Number	1263
Listing #	585554
Taxes	

COMMENTS

If you are looking to build your dream home here is the perfect opportunity. This buildable lot is 3.20 acres located close to Smithville and access to the GSP. There are "4" available lots, you can purchase these individually or as a package. The buyer will be responsible to have the well and septic installed along with confirmation of the taxes. See attached document...

PROPERTY FEATURES

CONTACT



Ask for Donna Brown
Berger Realty Inc
3160 Asbury Avenue, Ocean City
Call: 609-425-8352
Email to: dmb@bergerrealty.com

Scan to see Property page.



Berger Realty

Since 1926



Berger Realty, Inc.
3160 Asbury Avenue
Ocean City, NJ 08226
1-877-237-4371 / 609-399-0076
info@bergerrealty.com



851 Moss Mill Road, Galloway Township, NJ, 08205

Price \$135,000.00

PROPERTY DETAILS

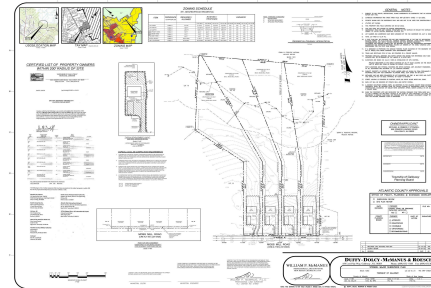

Total Rooms	
Bedrooms	0
Baths Full	0
Baths Half	0
Year Built	
Type	
Block Number	1263
Listing #	585554
Taxes	

COMMENTS

If you are looking to build your dream home here is the perfect opportunity. This buildable lot is 3.20 acres located close to Smithville and access to the GSP. There are "4" available lots, you can purchase these individually or as a package. The buyer will be responsible to have the well and septic installed along with confirmation of the taxes. See attached document...

PROPERTY FEATURES

CONTACT



Ask for Donna Brown
Berger Realty Inc
3160 Asbury Avenue, Ocean City
Call: 609-425-8352
Email to: dmb@bergerrealty.com

Scan to see Property page.

