

# Berger Realty

Since 1926



Berger Realty, Inc.  
3160 Asbury Avenue  
Ocean City, NJ 08226  
1-877-237-4371 / 609-399-0076  
info@bergerrealty.com



106 Leo, Egg Harbor Township, NJ, 08234

Price \$39,999.00



### PROPERTY DETAILS

Total Rooms	0
Bedrooms	0
Baths Full	0
Baths Half	0
Year Built	
Type	
Block Number	2804
Listing #	582258
Taxes	163.00

### COMMENTS

**SELLER DOES NOT HAVE ANY APPROVALS. BUYER MUST DO THEIR OWN DUE DILIGENCE.** Residential lot in understated neighborhood at the end of Leo Avenue. A 1/4 Pineland credit due to be purchased for individual lot sales. For multiple lot sales, the Buyer must do their own due diligence. Utilities are available. **BUYER MUST DO THEIR OWN DUE DILIGENCE....**

### PROPERTY FEATURES

### CONTACT



Ask for Sean McGinnis  
Berger Realty Inc  
3160 Asbury Avenue, Ocean City  
Call: 609-703-9955  
Email to: smc@bergerrealty.com

Scan to see Property page.



# Berger Realty

Since 1926



Berger Realty, Inc.  
3160 Asbury Avenue  
Ocean City, NJ 08226  
1-877-237-4371 / 609-399-0076  
info@bergerrealty.com



106 Leo, Egg Harbor Township, NJ, 08234

Price \$39,999.00

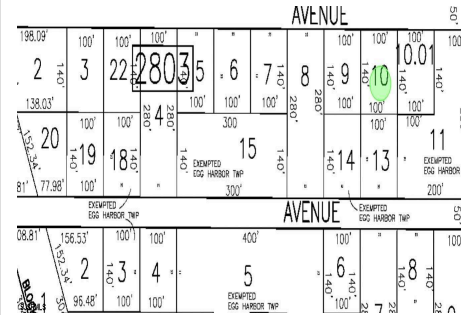

### PROPERTY DETAILS

Total Rooms	0
Bedrooms	0
Baths Full	0
Baths Half	0
Year Built	
Type	
Block Number	2804
Listing #	582258
Taxes	163.00

### COMMENTS

**SELLER DOES NOT HAVE ANY APPROVALS. BUYER MUST DO THEIR OWN DUE DILIGENCE.** Residential lot in understated neighborhood at the end of Leo Avenue. A 1/4 Pineland credit due to be purchased for individual lot sales. For multiple lot sales, the Buyer must do their own due diligence. Utilities are available. **BUYER MUST DO THEIR OWN DUE DILIGENCE....**

### PROPERTY FEATURES

### CONTACT



Ask for Sean McGinnis  
Berger Realty Inc  
3160 Asbury Avenue, Ocean City  
Call: 609-703-9955  
Email to: smc@bergerrealty.com

Scan to see Property page.

