

Berger Realty

Since 1926



Berger Realty, Inc.
3160 Asbury Avenue
Ocean City, NJ 08226
1-877-237-4371 / 609-399-0076
info@bergerrealty.com



106 Leo, Egg Harbor Township, NJ, 08234

Price \$39,999.00



PROPERTY DETAILS

Total Rooms 0
 Bedrooms 0
 Baths Full 0
 Baths Half 0
 Year Built
 Type
 Block Number 2804
 Listing # 582258
 Taxes 163.00

COMMENTS

SELLER DOES NOT HAVE ANY APPROVALS. BUYER MUST DO THEIR OWN DUE DILIGENCE. Residential lot in understated neighborhood at the end of Leo Avenue. A 1/4 Pineland credit due to be purchased for individual lot sales. For multiple lot sales, the Buyer must do their own due diligence. Utilities are available. **BUYER MUST DO THEIR OWN DUE DILIGENCE....**

PROPERTY FEATURES

CONTACT



Ask for Michelle Benson
 Berger Realty Inc
 3160 Asbury Avenue, Ocean City
 Call: 609-425-5886
 Email to: mb@bergerrealty.com

Scan to see Property page.



Berger Realty

Since 1926



Berger Realty, Inc.
3160 Asbury Avenue
Ocean City, NJ 08226
1-877-237-4371 / 609-399-0076
info@bergerrealty.com



106 Leo, Egg Harbor Township, NJ, 08234

Price \$39,999.00

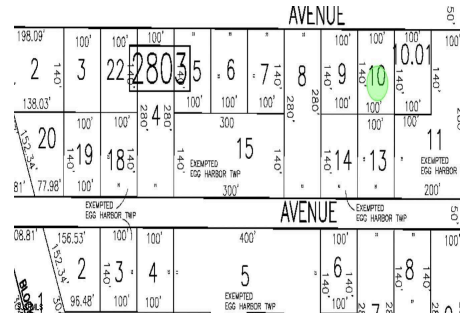

PROPERTY DETAILS

Total Rooms 0
 Bedrooms 0
 Baths Full 0
 Baths Half 0
 Year Built
 Type
 Block Number 2804
 Listing # 582258
 Taxes 163.00

COMMENTS

SELLER DOES NOT HAVE ANY APPROVALS. BUYER MUST DO THEIR OWN DUE DILIGENCE. Residential lot in understated neighborhood at the end of Leo Avenue. A 1/4 Pineland credit due to be purchased for individual lot sales. For multiple lot sales, the Buyer must do their own due diligence. Utilities are available. **BUYER MUST DO THEIR OWN DUE DILIGENCE....**

PROPERTY FEATURES

CONTACT



Ask for Michelle Benson
 Berger Realty Inc
 3160 Asbury Avenue, Ocean City
 Call: 609-425-5886
 Email to: mb@bergerrealty.com

Scan to see Property page.

