

# Berger Realty

Since 1928



Berger Realty, Inc  
1330 Bay Avenue  
Ocean City, NJ 08226  
609-391-1330/609-391-1300  
info@bergerrealty.com



601 Pittsburgh, Cape May, NJ, 08204

Price \$1,500,000.00

### PROPERTY DETAILS

Total Rooms	
Bedrooms	0
Baths Full	0
Baths Half	0
Year Built	
Type	Residential Vacant Lot
Block Number	1167
Listing #	241233
Taxes	541.00

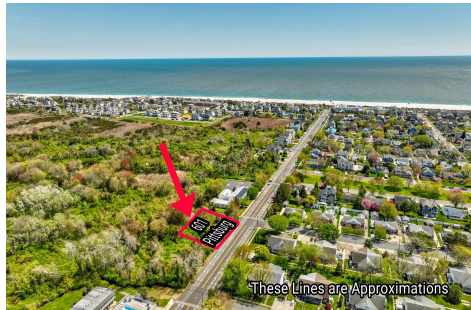

### COMMENTS

*Sizeable 125' x 125' single family home building lot within close proximity to the beach and Marina District adjacent to protected habitat. The Seller is working with an engineer to obtain a letter of interpretation from The State of New Jersey....*

### PROPERTY FEATURES

### CONTACT



Ask for Phillip Bellucci  
Berger Realty Inc  
1330 Bay Avenue, Ocean City  
Call: 609-432-3649  
Email to: [pjb@bergerrealty.com](mailto:pjb@bergerrealty.com)

Scan to see Property page.



# Berger Realty

Since 1928



Berger Realty, Inc  
1330 Bay Avenue  
Ocean City, NJ 08226  
609-391-1330/609-391-1300  
info@bergerrealty.com



601 Pittsburgh, Cape May, NJ, 08204

Price \$1,500,000.00

### PROPERTY DETAILS

Total Rooms	
Bedrooms	0
Baths Full	0
Baths Half	0
Year Built	
Type	Residential Vacant Lot
Block Number	1167
Listing #	241233
Taxes	541.00

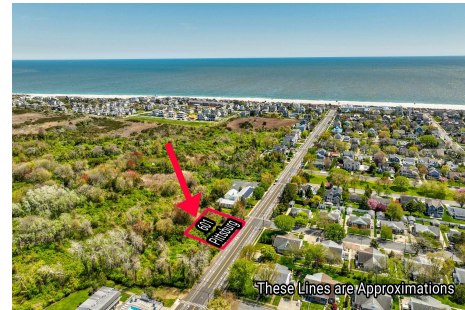

### COMMENTS

*Sizeable 125' x 125' single family home building lot within close proximity to the beach and Marina District adjacent to protected habitat. The Seller is working with an engineer to obtain a letter of interpretation from The State of New Jersey....*

### PROPERTY FEATURES

### CONTACT



Ask for Phillip Bellucci  
Berger Realty Inc  
1330 Bay Avenue, Ocean City  
Call: 609-432-3649  
Email to: [pjb@bergerrealty.com](mailto:pjb@bergerrealty.com)

Scan to see Property page.

