

# Berger Realty

Since 1928



Berger Realty, Inc.  
55th & Haven Avenue  
Ocean City, NJ 08226  
609-399-0040

info@bergerrealty.com



# Berger Realty

Since 1928



Berger Realty, Inc.  
55th & Haven Avenue  
Ocean City, NJ 08226  
609-399-0040

info@bergerrealty.com



886 Weeks Landing, Erma, NJ, 08204

Price \$325,000.00

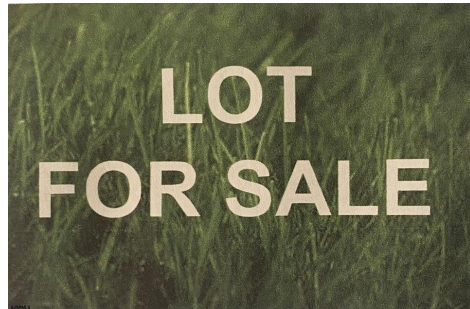

### PROPERTY DETAILS

Total Rooms	
Bedrooms	0
Baths Full	0
Baths Half	0
Year Built	
Type	Residential Vacant Lot
Block Number	510
Listing #	230590
Taxes	3202.00

### COMMENTS

Possible buildable lot in desirable neighborhood. Lot size is approximate 1.59 acre. Seller obtained letter from DEP when purchased and is included in Associated Docs along with subdivision plan with dimensions. All approvals or permits will be required to be performed by the buyer....

### PROPERTY FEATURES

### CONTACT



Ask for Valerie Vargo  
Berger Realty Inc  
109 E 55th St., Ocean City  
Call: 609-214-5780  
Email to: vlv@bergerrealty.com

Scan to see Property page.



886 Weeks Landing, Erma, NJ, 08204

Price \$325,000.00

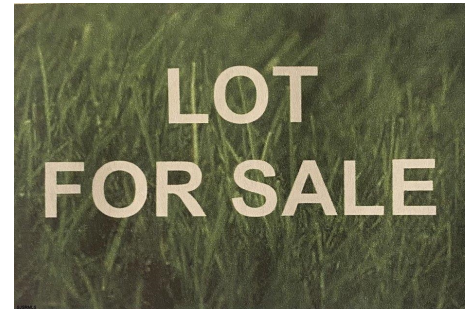

### PROPERTY DETAILS

Total Rooms	
Bedrooms	0
Baths Full	0
Baths Half	0
Year Built	
Type	Residential Vacant Lot
Block Number	510
Listing #	230590
Taxes	3202.00

### COMMENTS

Possible buildable lot in desirable neighborhood. Lot size is approximate 1.59 acre. Seller obtained letter from DEP when purchased and is included in Associated Docs along with subdivision plan with dimensions. All approvals or permits will be required to be performed by the buyer....

### PROPERTY FEATURES

### CONTACT



Ask for Valerie Vargo  
Berger Realty Inc  
109 E 55th St., Ocean City  
Call: 609-214-5780  
Email to: vlv@bergerrealty.com

Scan to see Property page.

