

Berger Realty

Since 1928



Berger Realty, Inc.
3160 Asbury Avenue
Ocean City, NJ 08226
1-877-237-4371 / 609-399-0076
✉ info@bergerrealty.com



26 Connecticut
Atlantic City, NJ 08401

Asking \$50,000.00

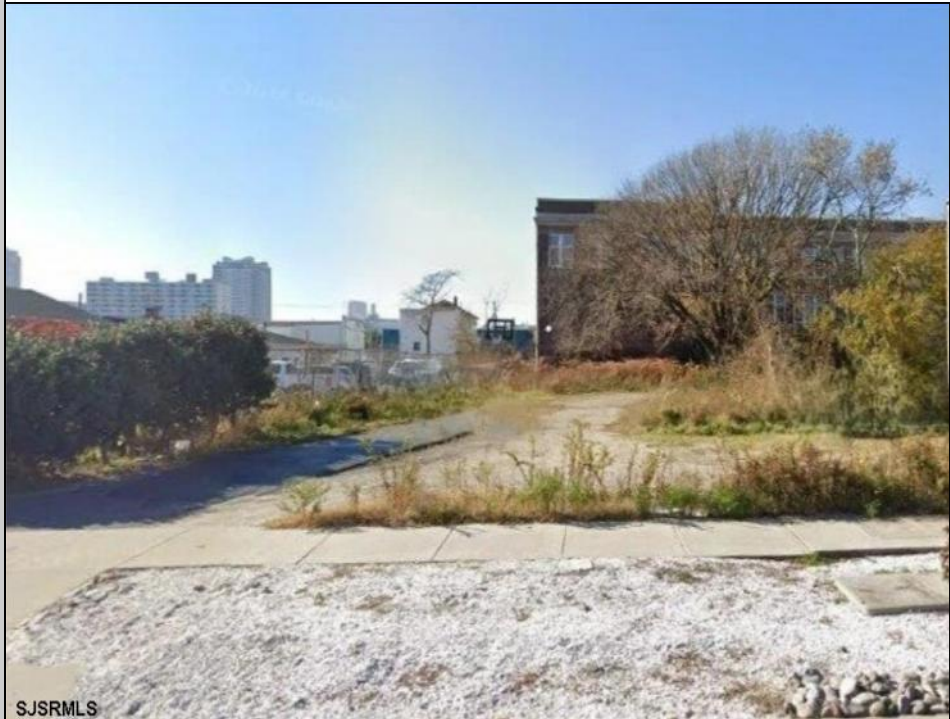

SJSRMLS

COMMENTS

VACANT BUILDABLE LAND!! Nearly 2,700 Square feet! Zoned: RM-1 for Moderate-to-high density, multi-unit residential buildings. This lot is ready for you to come build the multi-family investment property of your dreams! Lot size is approximately 25x107. Please free free to call CRDA for development questions: 609-347-0500.

PROPERTY DETAILS



Ask for Steven Orner
Berger Realty Inc
3160 Asbury Avenue, Ocean City
Call: 609-399-0076
Email to: slo@bergerrealty.com

