

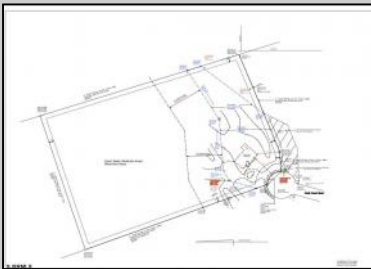

16 Holly Creek Rd
 Port Republic, NJ 08241

Asking \$1,250,775.00



SJSRMLS

COMMENTS

PORT REPUBLIC NEW LISTING ALERT4 BED 2.5 BATH 3,600 SQ FT RANCH LIVING WITH UNFINISHED 2ND FLOOR OF ANOTHER 750 SQ FT***10' CEILINGS THROUGHOUT, 12' IN FAMILY ROOM/KITCHEN***BLACK CASEMENT WINDOWS***GRAND KITCHEN W/ BUTLER SERVICE AREA***NATURAL GAS F/P OR OPTIONAL MASONRY WOOD BURNING FIREPLACE***3 CAR GARAGE***STUCCO FACADE & CEMENT BOARD SIDING ON SIDES/REAR***LARGE LANAI***COVERED FRONT PORCH***CENTRAL VAC***PAVED DRIVEWAY***LANDSCAPING PACKAGE***UNDERGROUND UTILITIES & NATURAL GAS***12.6 ACRES FARMLAND ASSESSED FOR TAX SAVINGS*** Whispers of Holly Creek~Shrouded in tranquility, this 12.6 acre piece of paradise in the ever-charming town of Port Republic is perfectly nestled at the end of a cul-de-sac. This to-be-built custom beauty will be impeccable in every way from materials to high-end craftsmanship. Convenience of ranch-style living, with the added bonus of an unfinished 2nd floor. This 2nd floor can be used for a multitude of purposes and finished at an additional cost if so desired. 5th bedroom would be a perfect scenario! Permits are already in place and ready for build upon contract!!! This spectacular opportunity to have a custom home on acreage is a rare find, turn this gem into your crown jewel!

PROPERTY DETAILS

Exterior Stucco	OutsideFeatures Porch	ParkingGarage Three or More Cars Attached Garage	InteriorFeatures Cathedral Ceiling
--------------------	--------------------------	--	---------------------------------------



Ask for Graham Ginn
 Berger Realty Inc
 3160 Asbury Avenue Ocean City
 Call: 609-399-0076
 Email to: gmg@bergerrealty.com
 https://www.ocnj.com



Basement
Crawl Space
Heating
Forced Air
Gas-Natural
Sewer
Septic