

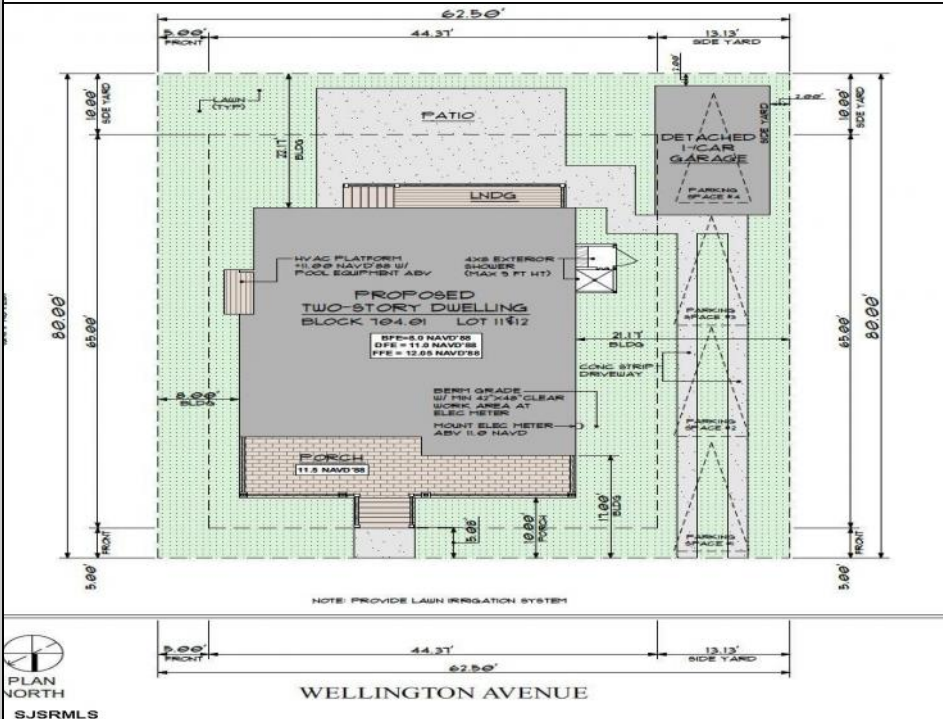

7605 Wellington
 Margate, NJ 08402

Asking \$995,000.00



COMMENTS

BUILDABLE OVERSIZED LOT IN MARGATE 5,000 sqft 62.5' frontage x 80' deep- Plenty of room for a POOL. Located in quiet no through street off N Clermont Avenue with plenty of on street parking for guests. No side neighbor lot is situated next to natural reserve & walking trails to the bay Price includes zoning approved plans by Lolio Architect, plans include 5 beds-4&1/2 bath, detached garage, oversized porches & decks, open kitchen-living-dining, two washer/dryer rooms, wet bar. Or, design your own dream home!

PROPERTY DETAILS

Ask for Donna M. Drohan
 Berger Realty Inc
 1330 Bay Avenue, Ocean City
 Call: 609-391-1330
 Email to: dmd@bergerrealty.com

