

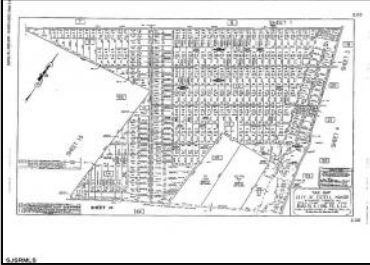

165 6th  
 Estell Manor, NJ 08319

Asking \$50,000.00



SJSRMLS

**COMMENTS**

Vacant land 5 acre wooded lot partially cleared. Buyer will be responsible to do any and all due diligence. Seller has had this land for many years but any approvals have long since expired. Contact listing agent if you have any questions.

**PROPERTY DETAILS**



Ask for Tara Crusser-Moss  
 Berger Realty Inc  
 3160 Asbury Avenue, Ocean City  
 Call: 609-399-0076  
 Email to: tcm@bergerrealty.com

