

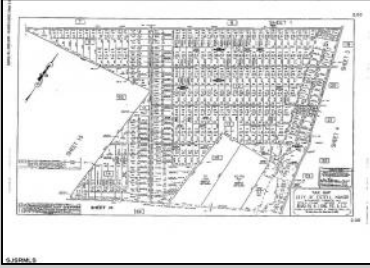

165 6th
 Estell Manor, NJ 08319

Asking \$50,000.00



SJSRMLS

COMMENTS

Vacant land 5 acre wooded lot partially cleared. Buyer will be responsible to do any and all due diligence. Seller has had this land for many years but any approvals have long since expired. Contact listing agent if you have any questions.

PROPERTY DETAILS



Ask for Joan S. Spencer
 Berger Realty Inc
 1330 Bay Avenue, Ocean City
 Call: 609-391-1330
 Email to: jss@bergerrealty.com

