

# Berger Realty

Since 1928

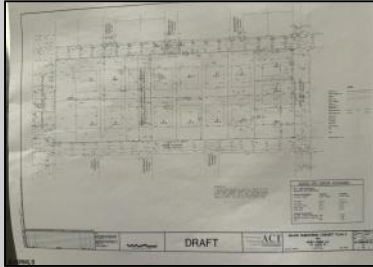

Berger Realty, Inc.  
3160 Asbury Avenue  
Ocean City, NJ 08226  
1-877-237-4371 / 609-399-0076  
✉ [info@bergerrealty.com](mailto:info@bergerrealty.com)



1316 Bella Donna  
Galloway Township, NJ 08215

Asking \$595,000.00



#### COMMENTS

HAVE PLANS FOR 17 SINGLE FAMILY RESIDENTIAL BUILDING LOTS IN GALLOWAY TOWNSHIP WITH ALL UTILITIES ON 6.82 ACRES OR MULTI FAMILY, COMMERCIAL OFFICE OR RETAIL BUSINESS ARE PERMITTED. PROPERTY IS PHILADELPHIA AVENUE TO CAPE MAY AVENUE AND BELLA DONNA AVENUE TO RENE AVENUE.

#### PROPERTY DETAILS



Ask for Patricia (Trish) Spengler  
Berger Realty Inc  
3160 Asbury Avenue, Ocean City  
Call: 609-399-0076  
Email to: [pjs@bergerrealty.com](mailto:pjs@bergerrealty.com)

