

Berger Realty

Since 1928



Berger Realty, Inc.
3160 Asbury Avenue
Ocean City, NJ 08226
1-877-237-4371 / 609-399-0076
info@bergerrealty.com



Route 50
Mays Landing, NJ 08330

Asking \$19,000.00

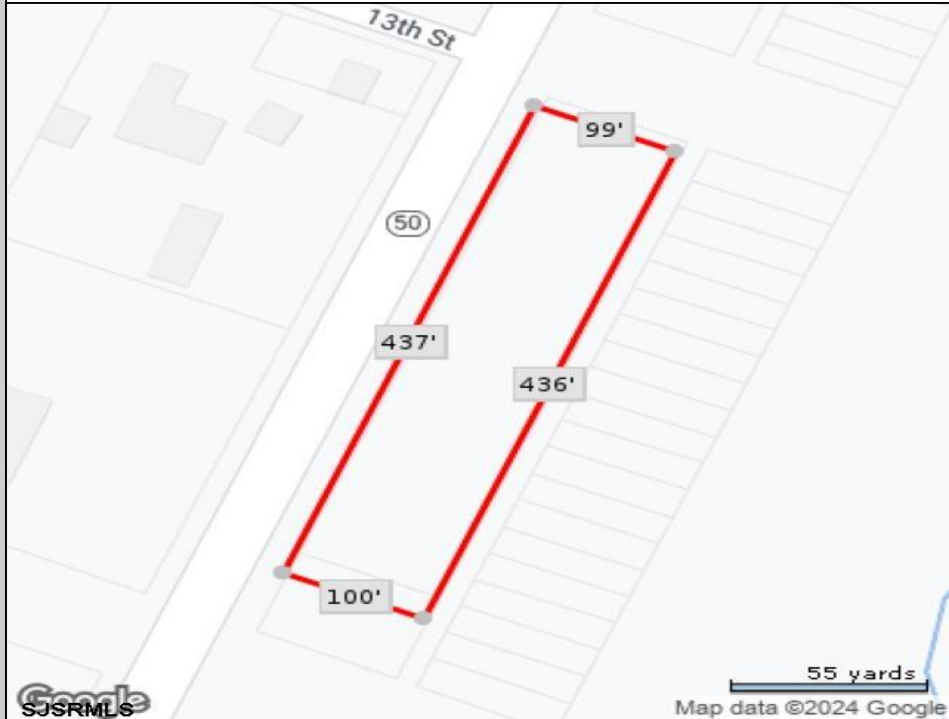

SJSRMLS

55 yards
Map data ©2024 Google

COMMENTS

440' Road frontage located in the heart of town and business district. High traffic location. See associated documents.

PROPERTY DETAILS



Ask for Theresa Maina
Berger Realty Inc
3160 Asbury Avenue, Ocean City
Call: 609-399-0076
Email to: tam@bergerrealty.com

