

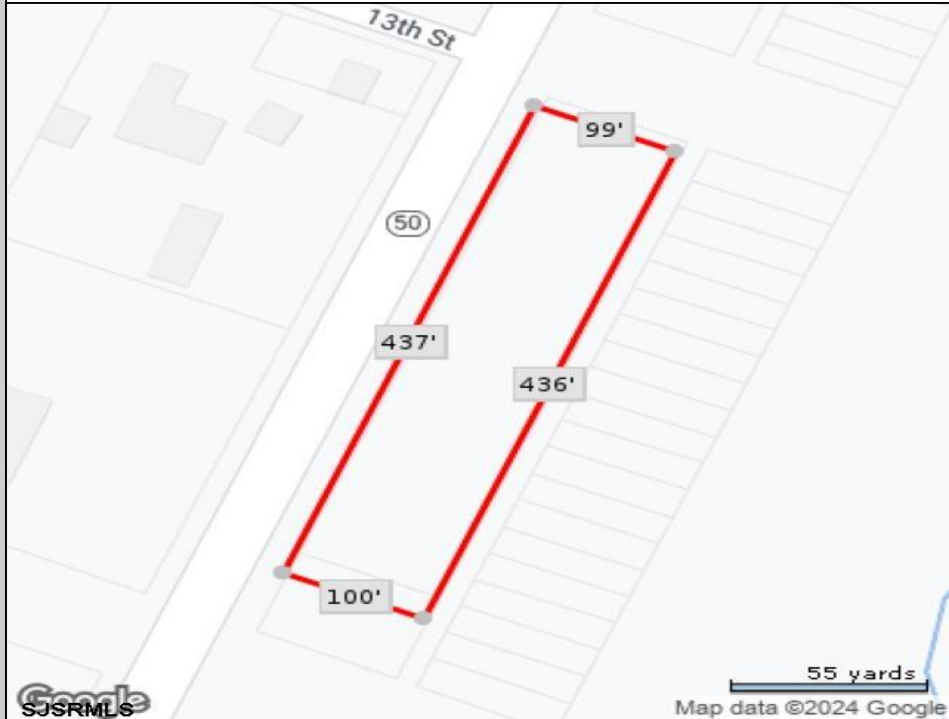

Route 50
Mays Landing, NJ 08330

Asking \$19,000.00



SJSRMLS

55 yards
Map data ©2024 Google

COMMENTS

440' Road frontage located in the heart of town and business district. High traffic location. See associated documents.

PROPERTY DETAILS



Ask for Michael Moss
Berger Realty Inc
3160 Asbury Avenue, Ocean City
Call: 609-399-0076
Email to: mvm@bergerrealty.com

