

Route 50  
Mays Landing, NJ 08330

Asking \$19,000.00

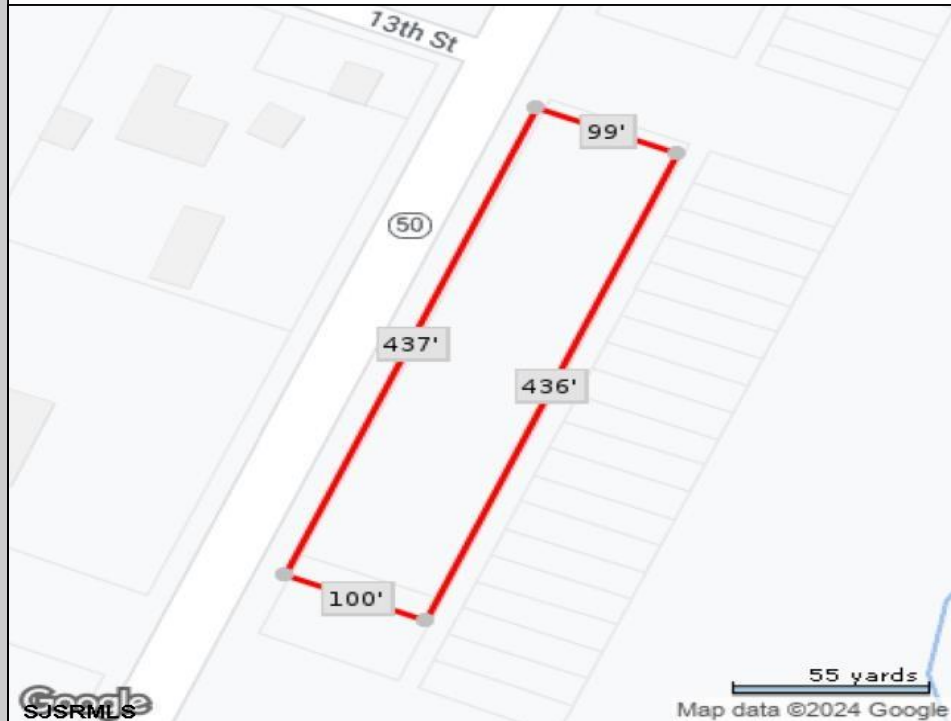

SJSRMLS

55 yards  
Map data ©2024 Google

### COMMENTS

440' Road frontage located in the heart of town and business district. High traffic location. See associated documents.

### PROPERTY DETAILS



Ask for Duane Jarvis  
Berger Realty Inc  
109 E 55th St., Ocean City  
Call: 609-399-4211  
Email to: dej@bergerrealty.com

