

# Berger Realty

Since 1928

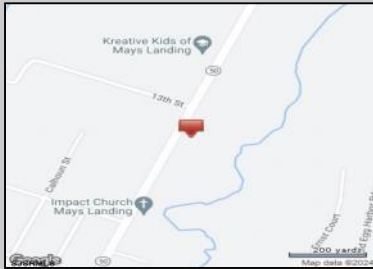

Berger Realty, Inc  
1330 Bay Avenue  
Ocean City, NJ 08226  
609-391-1330/609-391-1300  
info@bergerrealty.com



Route 50  
Mays Landing, NJ 08330

Asking \$19,000.00

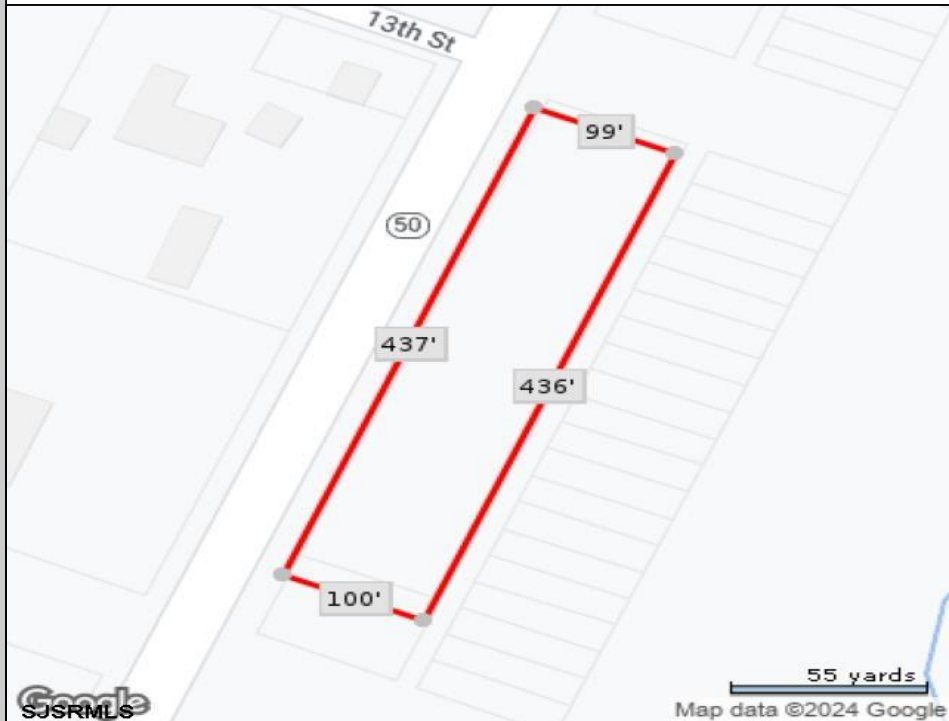

#### COMMENTS

440' Road frontage located in the heart of town and business district. High traffic location. See associated documents.

#### PROPERTY DETAILS



Ask for Barbara Fasy  
Berger Realty Inc  
1330 Bay Avenue, Ocean City  
Call: 609-391-1330  
Email to: bf@bergerrealty.com

