

# Berger Realty

Since 1928

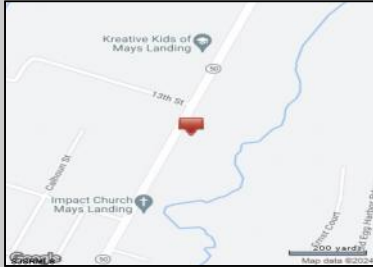

Berger Realty, Inc.  
3160 Asbury Avenue  
Ocean City, NJ 08226  
1-877-237-4371 / 609-399-0076  
info@bergerrealty.com



Route 50  
Mays Landing, NJ 08330

Asking \$19,000.00

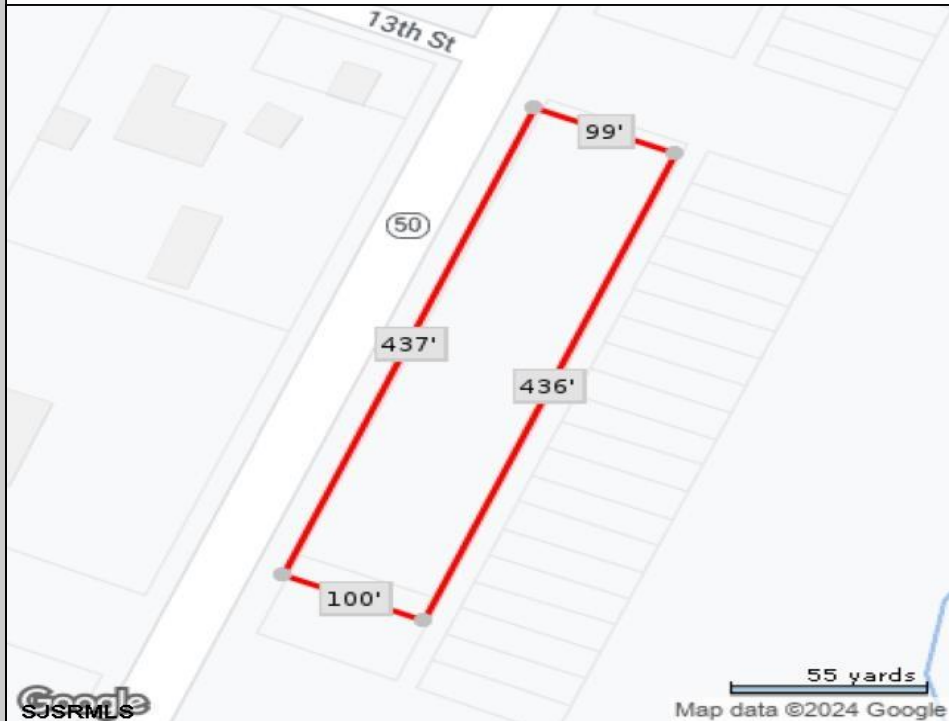

#### COMMENTS

440' Road frontage located in the heart of town and business district. High traffic location. See associated documents.

#### PROPERTY DETAILS



Ask for Barbara Varacalli  
Berger Realty Inc  
3160 Asbury Avenue, Ocean City  
Call: 609-399-0076  
Email to: bav@bergerrealty.com

