

Berger Realty

Since 1928



Berger Realty, Inc.
 3160 Asbury Avenue
 Ocean City, NJ 08226
 1-877-237-4371 / 609-399-0076
 info@bergerrealty.com



106 Leo
 Egg Harbor Township, NJ 08234

Asking \$39,999.00

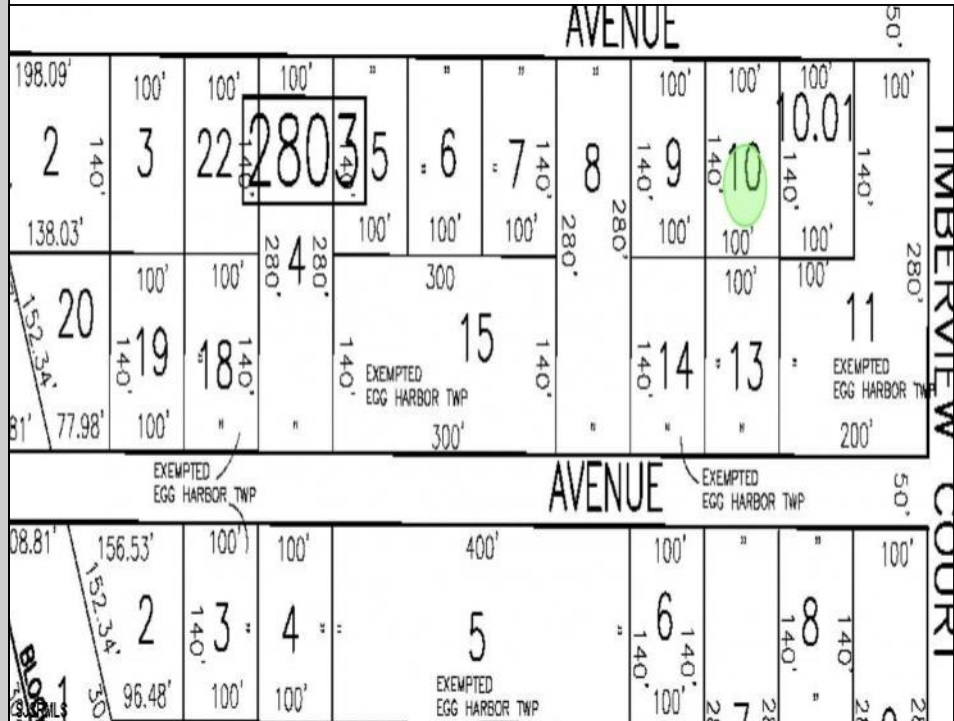

COMMENTS

SELLER DOES NOT HAVE ANY APPROVALS. BUYER MUST DO THEIR OWN DUE DILIGENCE. Residential lot in understated neighborhood at the end of Leo Avenue. A 1/4 Pineland credit due to be purchased for individual lot sales. For multiple lot sales, the Buyer must do their own due diligence. Utilities are available. BUYER MUST DO THEIR OWN DUE DILIGENCE.

PROPERTY DETAILS



Ask for Karen A. Becker
 Berger Realty Inc
 3160 Asbury Avenue, Ocean City
 Call: 609-399-0076
 Email to: kab@bergerrealty.com

