



4420 Park  
Sea Isle City, NJ 08243

Asking \$4,100,000.00

## #4420 Park Road



PARK ROAD ELEVATION

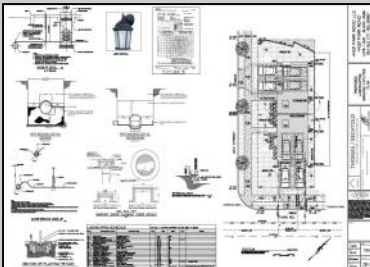
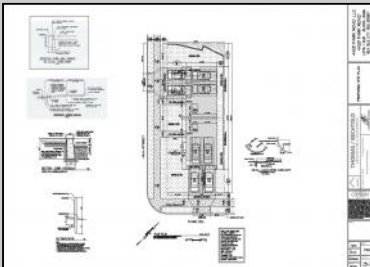

### COMMENTS

Coming soon!! Bayfront! Now is your opportunity to own a brand-new duplex on Park Road in Sea Isle City. With 2 units, each containing 4 beds and 3.5 baths, this home is perfect for the whole family. Built by Sea Isle's own Michael O'Neill, you won't want to miss this one! The property includes an elevator, private decks on all 3 floors, attached 2-car garage, new bulkhead and a boat slip. The location is steps to the bay and within walking distance to local restaurants, shops, the promenade and beaches

### PROPERTY DETAILS

|                 |               |                |             |
|-----------------|---------------|----------------|-------------|
| OutsideFeatures | ParkingGarage | OtherRooms     | Heating     |
| Deck            | Garage        | Living Room    | Gas Natural |
| Dock/Boat Slip  | 2 Car         | Dining Room    | Forced Air  |
| Bulkhead        | Attached      | Eat In Kitchen |             |
| Sidewalks       |               | Pantry         |             |
| Waterview       |               |                |             |
| Cooling         | HotWater      | Water          | Sewer       |
| Central Air     | Gas           | City           | City        |
| Ceiling Fan     |               |                |             |
| Multi Zoned     |               |                |             |



Ask for Bob Wilkins  
Berger Realty Inc  
109 E 55th St., Ocean City  
Call: 609-399-4211  
Email to: bw@bergerrealty.com

