



4420 Park
Sea Isle City, NJ 08243

Asking \$2,100,000.00

4420 Park Road



PARK ROAD ELEVATION

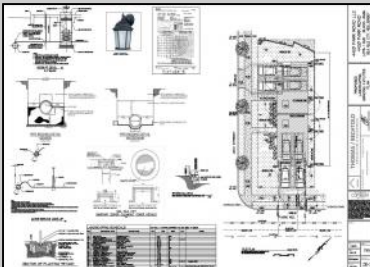
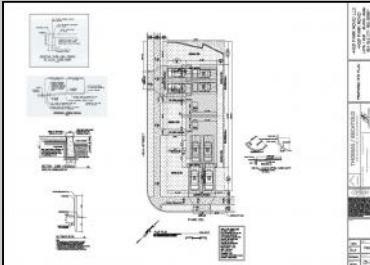

COMMENTS

Coming Soon!! Bayfront! Now is your opportunity to own a brand-new, waterfront townhouse on Park Road in Sea Isle City. With 4 beds and 3.5 baths, this home is perfect for the whole family. Built by Sea Isle's own Michael O'Neill, you won't want to miss this one! The property includes an elevator, private decks on all 3 floors, attached 2-car garage, new bulkhead and a boat slip. The location is steps to the bay and within walking distance to local restaurants, shops, the promenade and beaches.

PROPERTY DETAILS

Unit Features	Parking/Garage	Other Rooms	Appliances Included
Kitchen Island	Garage	Living Room	Self-Clean Oven
Walk-In/Cedar Closet	2 Car	Dining Room	Microwave Oven
Elevator	Attached	Eat In Kitchen	Refrigerator
		Pantry	Washer
			Dryer
			Dishwasher
Heating	Cooling	Hot Water	Water
Gas Natural	Central Air	Gas	City
Forced Air	Ceiling Fan		
	Multi Zoned		



Ask for Michael Moss
 Berger Realty Inc
 3160 Asbury Avenue, Ocean City
 Call: 609-399-0076
 Email to: mvm@bergerrealty.com

